

This drawing is for spatial consideration only. Do not pre-plumb to these dimensions.

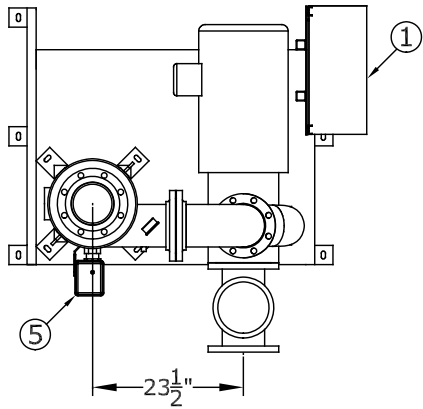

PLAN VIEW

NOTES:

1. SYSTEM INLET: 6" IPS (CLASS 150 FLANGE)
2. SYSTEM OUTLET: 6" IPS (CLASS 150 FLANGE)
3. PURGE OUTLET: 1-1/2" FPT
4. MAXIMUM PRESSURE: 150 psi (10.3 bar)
5. SYSTEM FLOWRATE: 1100 gpm
6. MAXIMUM OPERATING TEMPERATURE: 120°F (49°C)
7. FLOODED SUCTION REQUIRED
8. INLET/OUTLET VALVE KIT (OPTIONAL) - NOT SHOWN

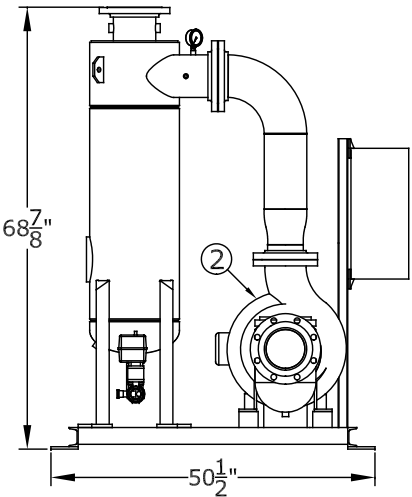

ELEVATION VIEW

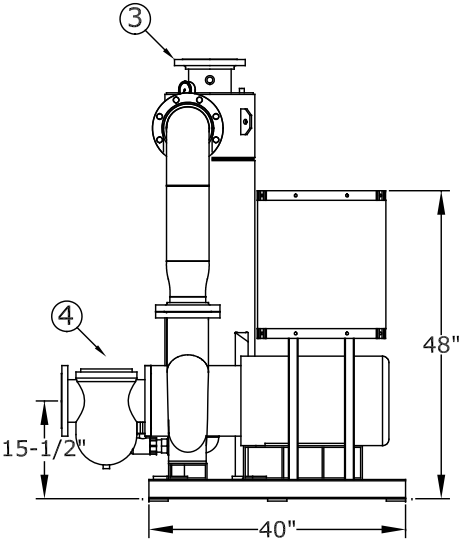

SIDE VIEW

COMPONENT LIST

- ① ELECTRICAL CONTROL PANEL
- ② PUMP
- ③ SEPARATOR: CS-6T-FLG
- ④ BASKET STRAINER (OPTIONAL) - SHIPPED LOOSE
- ⑤ PURGE VALVE

THIS DOCUMENT MAY CONTAIN PROPRIETARY INFORMATION. IT MAY NOT BE REPRODUCED OR TRANSFERRED TO OTHERS OR USED FOR MANUFACTURING OR ANY OTHER PURPOSE WITHOUT PRIOR WRITTEN PERMISSION.		GRISWOLD WATER SYSTEMS			
		1525 EAST SIXTH STREET, CORONA, CA 92879			
		GLS-601-HH			
DRAWN RK	DATE: 07-25-13	MATERIAL: CARBON STEEL	DRAWING NO. -	SIZE A	REV. A
APPRD -	DATE: -	WEIGHT: 1300 lbs. (591 kg.)	SCALE -	SHEET 1 OF 1	