

FB-Series Pot Feeder Installation/Operation

DESCRIPTION:

All models have a large 3-1/2" opening and include the exclusive "Safety Lid Assembly". This opening can be used without a funnel. The design allows easy addition of chemicals without tools, and will release captive pressure without allowing the lid to separate from the feeder. The FB-Series of pot feeders may be used as a pot feeder only, or as a combination pot feeder and filter. All models are made of carbon steel rated at 200°F @ 200psi.

INSTALLATION:

The FB-Series pot feeder may be installed across a pump. Please note that the inlet may be at the top or at the bottom depending on installation ease, unless a strainer basket is used; then the inlet must be at the top. If the Funnel Package is not used, a 3/4"NPT plug may be installed to close one of the upper connections. There must be a Drain Valve installed in the lower connection line to the feeder. This Drain Valve is necessary so the feeder can be drained to allow chemicals to be added to the feeder.

OPERATION (Without Funnel Package):

Close the inlet and outlet valves. Slowly open the drain valve at the lower connection to relieve pressure. Make sure all pressure is released. Remove the Safety-Lid Assembly. Wait for the feeder to drain, close drain valve. Add Chemicals, install lid. Open inlet and outlet valves. The feeder is in operation.

OPERATION (With Funnel Package):

Keep body away from Funnel opening. Close the inlet and outlet valves. Slowly open the drain valve at the lower connection to relieve pressure. Slowly open the vent on the Funnel Valve. Make sure all pressure is released then close vent. Wait for the feeder to drain, close drain valve. Add Chemicals, close Funnel Valve. Open inlet and outlet valves. The feeder is in operation.

OPERATION (With Strainer or Strainer Bag):

The Strainer may be used alone. The bag requires the Strainer. The bag is larger than the Strainer for support. Press the bag into the Strainer. Fluid flow will not extend the bag into the Strainer, so you must manually extend the bag into the Strainer. If the bag is not manually extended into the Strainer during installation, there is a possibility the bag will rupture.

Close the inlet and outlet valves. Slowly open the drain valve at the lower connection to relieve pressure. Make sure all pressure is released. Using the wrench provided, remove the Safety-Lid Assembly. Wait for the feeder to drain, close drain valve. Add Chemicals, install lid. Open inlet and outlet valves. The feeder is in operation.

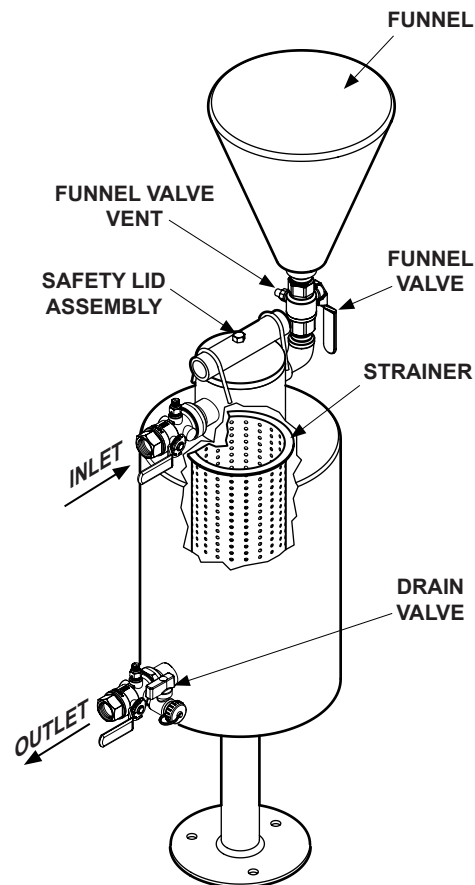

GE-Series Pot Feeder Installation/Operation

DESCRIPTION:

All models have a large 3-1/2" opening and include the exclusive "Bolt-On Safety Lid Assembly". This opening can be used without a funnel. The design allows easy addition of chemicals due to its large opening. The GE-Series of pot feeders may be used as a pot feeder only, or as a combination pot feeder and filter. All models are made of carbon steel rated at 200°F @ 200psi.

INSTALLATION:

The GE-Series pot feeder may be installed across a pump. Please note that the inlet may be at the top or at the bottom depending on installation ease, unless a strainer basket is used; then the inlet must be at the top. If the Funnel Package is not used, a 3/4"NPT plug may be installed to close one of the upper connections. There must be a Drain Valve installed in the lower connection line to the feeder. This Drain Valve is necessary so the feeder can be drained to allow chemicals to be added to the feeder.

OPERATION (Without Funnel Package):

Close the inlet and outlet valves. Slowly open the drain valve at the lower connection to relieve pressure. Make sure all pressure is released. Remove the Safety-Lid Assembly. Wait for the feeder to drain, close drain valve. Add Chemicals, install lid. Open inlet and outlet valves. The feeder is in operation.

OPERATION (With Funnel Package):

Keep body away from Funnel opening. Close the inlet and outlet valves. Slowly open the drain valve at the lower connection to relieve pressure. Slowly open the vent on the Funnel Valve. Make sure all pressure is released then close vent. Wait for the feeder to drain, close drain valve. Add Chemicals, close Funnel Valve. Open inlet and outlet valves. The feeder is in operation.

OPERATION (With Strainer or Strainer Bag):

The Strainer may be used alone. The bag requires the Strainer. The bag is larger than the Strainer for support. Press the bag into the Strainer. Fluid flow will not extend the bag into the Strainer, so you must manually extend the bag into the Strainer. If the bag is not manually extended into the Strainer during installation, there is a possibility the bag will rupture.

Close the inlet and outlet valves. Slowly open the drain valve at the lower connection to relieve pressure. Make sure all pressure is released. Using the wrench provided, remove the Safety-Lid Assembly. Wait for the feeder to drain, close drain valve. Add Chemicals, install lid. Open inlet and outlet valves. The feeder is in operation.

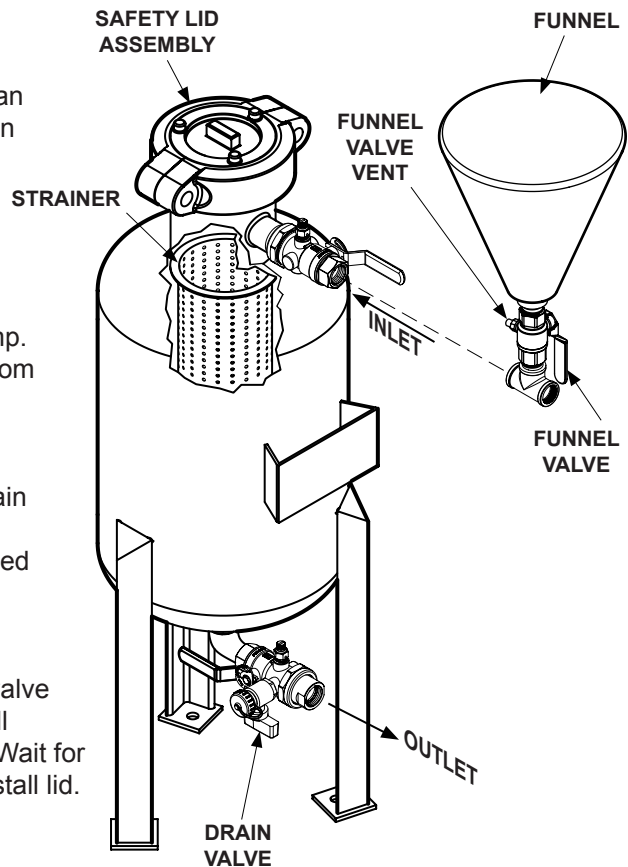

CF-Series Pot Feeder Installation/Operation

DESCRIPTION:

All models have a large 3-1/2" opening and include the exclusive "Safety Lid Assembly". This opening can be used without a funnel. The design allows easy addition of chemicals without tools, and will release captive pressure without allowing the lid to separate from the feeder. The CF-Series of pot feeders may be used as a pot feeder, or as a combination pot feeder and filter. All models are made of carbon steel rated at 200°F @ 200psi.

INSTALLATION:

The CF-Series pot feeder may be installed in a pressure line or across a pump. The inlet for the CF-Series pot feeder must be at the bottom.

(The Funnel Package is not an option with the CF-Series Pot Feeder)

OPERATION:

Close the inlet and outlet valves. Slowly open the drain valve at the lower connection to relieve pressure. Make sure all pressure is released. Remove the Safety-Lid Assembly. Wait for the feeder to drain, close drain valve. Add Chemicals, install lid. Open inlet and outlet valves. The feeder is in operation.

CARTRIDGE FILTER REPLACEMENT:

Remove cartridge filter from pot feeder. Remove the bottom retainer from cartridge bracket. Remove old cartridge and replace with new one.

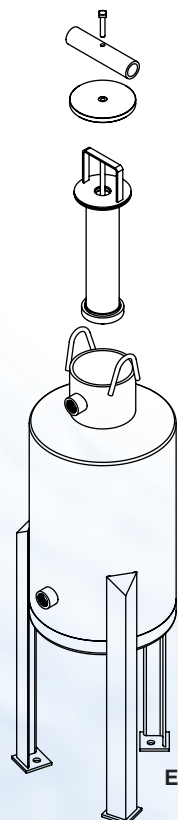
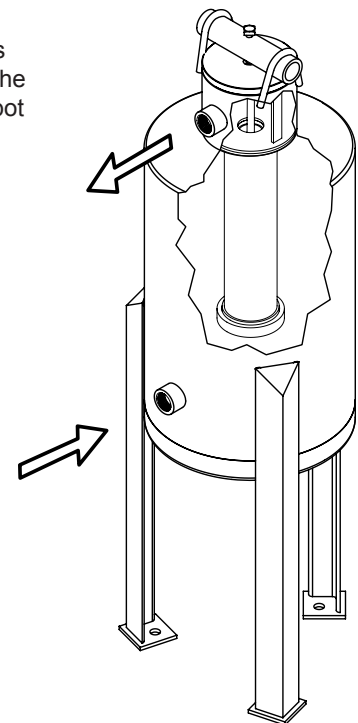

EXPLODED VIEW

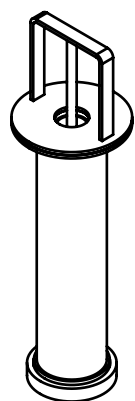

CARTRIDGE FILTER

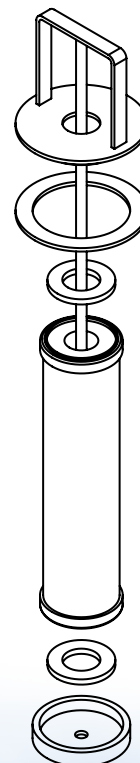

CARTRIDGE FILTER EXPLODED